

- GENERAL NOTE:**
- G.C. TO PROVIDE BLOCKING FOR ALL WALL MOUNTED EQUIPMENT, PLUMBING FIXTURES AND MILLWORK.
 - G.C. SHALL BE RESPONSIBLE FOR INSTALLATION OF ALL STAINLESS STEEL WALL SHELVING, PLUMBING FIXTURES AND MILLWORK UON.
 - G.C. TO SET IN PLACE AND LEVEL ALL STN. STEEL EQUIPMENT. UON.
 - G.C. TO CAULK AND SEAL AT ALL STN. STEEL EQUIPMENT AFTER SET IN PLACE AND LEVEL TO COMPLY WITH HEALTH DEPARTMENT REQUIREMENTS.
 - G.C. TO PROVIDE STN. STL. STORAGE SHELF ABOVE MOP SINK

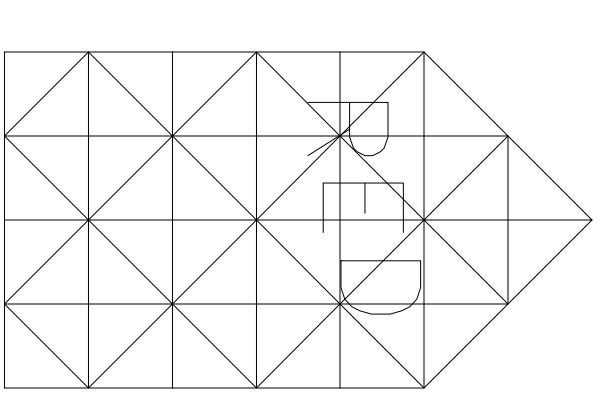

**RESTAURANT
EQUIPMENT
DESIGN
INC.**

727 KENNEDY STREET
OAKLAND, CALIFORNIA 94606
510.261.7300
510.261.8470

HEALTH SUBMITTAL **XX**

Issue Description Date

PROJECT
NORTH

RODERICK W. RENSCHOW
2300 FIRST ST.
LIVERMORE, CA94550

THESE DRAWINGS AND SPECIFICATIONS AND THE CONCEPTS EMBODIED THEREIN, HEREBY CONSTITUTE THE ORIGINAL UNRECORDED WORKS OF RESTAURANT EQUIPMENT DESIGN, CONSULTING ENGINEER, Roderick W. Renshaw, License No. C-13221, State of California. NO PART OF THESE DRAWINGS OR SPECIFICATIONS OR ANY INVENTIONS, PATENTS, TRADE SECRETS OR KNOWLEDGE HEREIN IS TO BE REPRODUCED OR TRANSMITTED IN ANY FORM OR BY ANY MEANS, WITHOUT THE WRITTEN PERMISSION OF THE ENGINEER.

Date: _____

Drawn By: **SS** Check: **JYKN/PB**

Job Abbr: **OT091T** Scale: **1/4" = 1'-0"**

EQUIPMENT PLAN

Sheet: **K30**

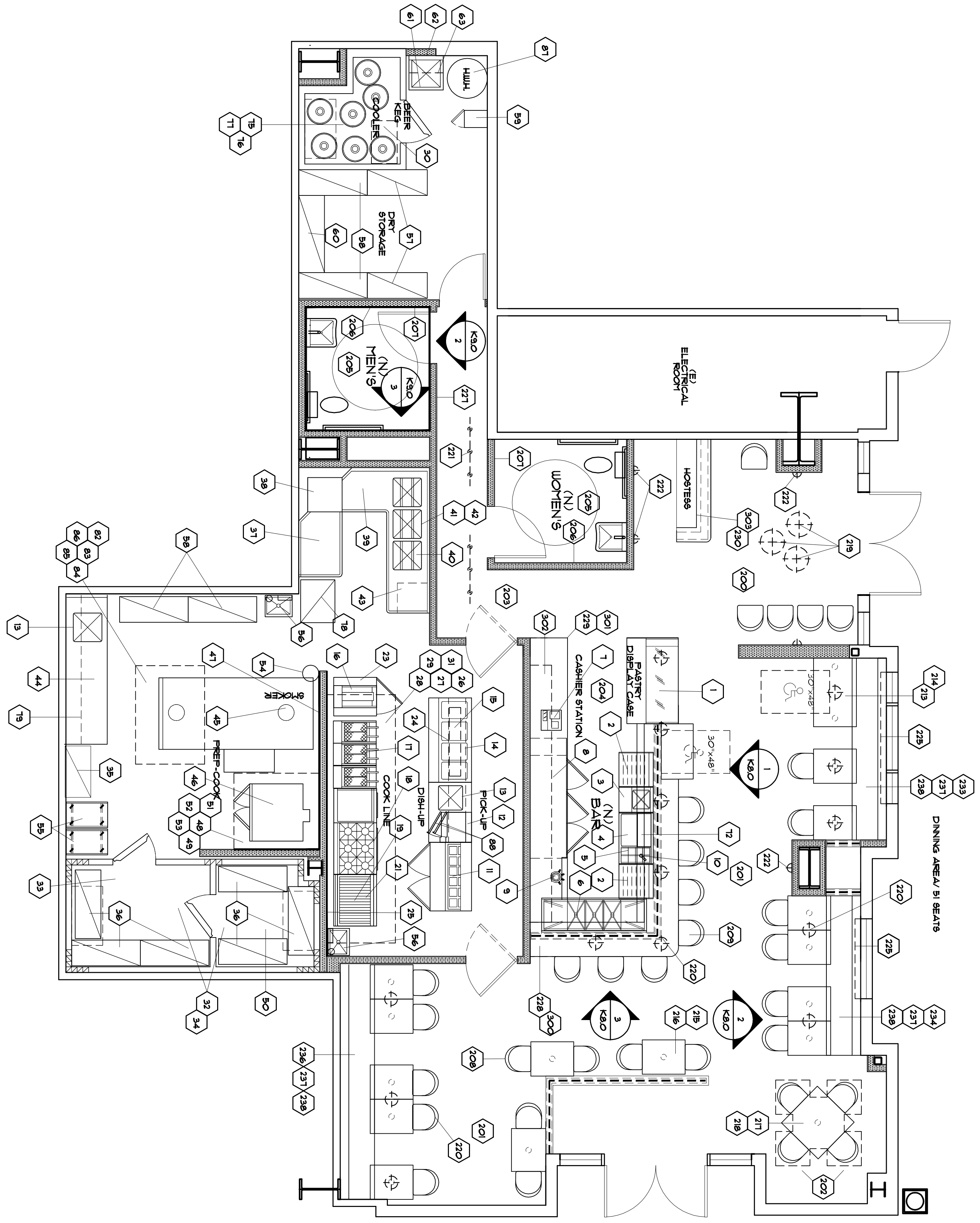

**FOR EQUIPMENT
SCHEDULE SEE K32**